

OK

# THE CITY OF NAPOLEON

BUILDING & ZONING DEPARTMENT

255 W. RIVERVIEW

(419)592-4010

**Building Permit**

Permit Number: BP2007-53

Page 1 of 2

Printed: 5/1/2007

**ADDRESS:**

**1115 Kenilworth Ave.**

**Applicant**

**Name:** Hershberger Construction LTD  
**Address:** 912 Woodlawn Ct

**Approval Date:** 5/1/2007  
419-592-1210

**Owners**

**Name:** Ms. Cheryl Hershberger  
**Address:** 1115 Kenilworth Ave  
Napoleon, OH 43545

**Phone:** 419-966-6999

**Contractors**

**Contractor Type:** GENERAL CONTRACTOR  
**Name:** Hershberger Construction LTD  
**Address:** 912 Woodlawn Ct  
*@hod*

Napoleon, OH 43545

**Phone:** 419-592-1210

**Contractors**

**Contractor Type:** Builder  
**Name:** JA Hillis LLC  
**Address:** 13645 County Road M

Napoleon, OH 43545

**Phone:** 419-591-1410

**Fees and Receipts:**

Number	Description	Amount
FEE2007-234	Building Permit Fee (Auto)	\$19.00
<b>Total Fees:</b>		<b>\$19.00</b>
RCPT2007-202		\$19.00
<b>Total Receipts:</b>		<b>\$19.00</b>

concrete patio

APPLICANT'S SIGNATURE:



DATE:

5-1-07



# CITY OF NAPOLEON GENERAL PERMIT APPLICATION

THIS APPLICATION IS FOR RESIDENTIAL CONSTRUCTION INCLUDING BUILDING, ELECTRICAL, PLUMBING, MECHANICAL, DEMOLITIONS, REMODELING.

DATE: 5-1-07 JOB LOCATION: 1115 KENILWORTH AVE.

OWNER: Cheryl HERSHBERGER PHONE: 419-966-6999

OWNER ADDRESS: 1115 KENILWORTH AVE CITY: Napoleon ZIP: 43545

CONTRACTOR: HERSHBERGER CONSTRUCTION

PHONE #: 419-592-1210 CELL PHONE# 419-966-3011

CONTRACTOR LICENSED WITH THE CITY OF NAPOLEON?: YES  NO:

Is any of the above job going to be subcontracted out? Yes  No:

If yes to whom: J.A. Hillis

DESCRIPTION OF WORK TO BE PERFORMED: CONCRETE PATIO

ESTIMATED COMPLETION DATE: 5-15-07

## PLEASE MARK THE TYPE OF WORK YOU WILL BE PERFORMING

- |   |  |
|---|--|
| <input type="checkbox"/> A/C ADD ON                 | <input type="checkbox"/> REMODELING              |
| <input type="checkbox"/> BOILER REPLACEMENT         | <input type="checkbox"/> ROOFING                 |
| <input type="checkbox"/> CURBING                    | <input type="checkbox"/> SEWER REPAIRS**         |
| <input type="checkbox"/> DECKS *                    | <input type="checkbox"/> SIDEWALK*               |
| <input type="checkbox"/> DRIVEWAY*                  | <input type="checkbox"/> SIDING                  |
| <input type="checkbox"/> ELECTRICAL SERVICE UPGRADE | <input type="checkbox"/> STORAGE SHED*           |
| <input type="checkbox"/> ELECTRICAL SERVICE NEW     | <input type="checkbox"/> SWIMMING POOL*          |
| <input type="checkbox"/> FENCE*                     | <input type="checkbox"/> FURNACE REPLACEMENT     |
| <input type="checkbox"/> ADDITIONS*                 | <input type="checkbox"/> TEMP ELECTRIC           |
| <input type="checkbox"/> FURNACE NEW                | <input type="checkbox"/> WATER TAP (size _____") |
| <input type="checkbox"/> LAWN METER                 | <input type="checkbox"/> WINDOWS                 |
| <input type="checkbox"/> PLUMBING                   | <input type="checkbox"/> ZONING                  |

\*PLEASE INCLUDE A PICTURE SHOWING MEASUREMENTS FROM EXISTING STRUCTURES AND PROPERTY LINES. INDICATING THE TYPE OF WORK YOU WISH TO PERFORM.

\*\* IF WORK REQUIRES GOING INTO THE STREET A STREET BOND IS REQUIRED!

FOR PERMIT COSTS PLEASE FILL OUT REVERSE SIDE.

**PERMIT COST WORKSHEET**

<u>JOB</u>	<u>BASE FEE</u>	<u>TOTAL</u>
SIDING (only) TOTAL SQ _____ X 1.00 +	\$5.00 =	\$ _____
ROOFING (only) TOTAL SQ _____ X 1.00 +	\$5.00 =	\$ _____
WINDOWS / DOORS(only) # ___ X 1.00 +	\$5.00 =	\$ _____
ELECTRICAL # OF CIRCUITS _____ X 3.00 +	\$15.00 =	\$ _____
ELECTRICAL SERVICE UPGRADE	\$15.00 =	\$ _____
PLUMBING (INSIDE) replacing/ repairs	\$10.00 =	\$ _____
SEWER (OUTSIDE)	\$25.00 =	\$ _____
WATER HEATER	\$5.00	\$ _____
SHED UNDER 200 SQ FT (over 200 see chart)	\$ 5.00	\$ _____
FURNACE OR A/C (REPLACEMNT)	\$ 5.00	\$ _____
DEMOLITION (only)	\$30.00	\$ _____
SIDEWALK REPLACEMENT/ NEW	\$25.00	\$ _____
DRIVEWAY	\$25.00	\$ _____

ALL CONSTRUCTION, ALTERATIONS, REMODELING, SHEDS, DECKS & FENCES NOT LISTED ABOVE IS BASED ON COST OF WORK BEING PERFORMED.

COST OF WORK \$ 5700<sup>00</sup> (SEE CHART) \$ 19<sup>00</sup>

0.00	-	250.00	0.00	11,000.00	-	11,999.00	25.00
250.00	-	1,000.00	10.00	12,000.00	-	12,999.00	26.00
1,000.00	-	1,999.00	12.00	13,000.00	-	13,999.00	27.00
2,000.00	-	2,999.00	14.00	14,000.00	-	14,999.00	28.00
3,000.00	-	3,999.00	16.00	15,000.00	-	15,999.00	29.00
4,000.00	-	4,999.00	18.00	16,000.00	-	16,999.00	30.00
5,000.00	-	5,999.00	19.00	17,000.00	-	17,999.00	31.00
6,000.00	-	6,999.00	20.00	18,000.00	-	18,999.00	32.00
7,000.00	-	7,999.00	21.00	19,000.00	-	19,999.00	33.00
8,000.00	-	8,999.00	22.00	20,000.00	-	20,999.00	34.00
9,000.00	-	9,999.00	23.00	21,000.00	-	21,999.00	35.00
10,000.00	-	10,999.00	24.00	22,000.00	-	22,999.00	36.00
				Over 22,999		Please Call	

\*OTHER FEES NOT LISTED MAY APPLY

15'4" | PROPERTY LINE

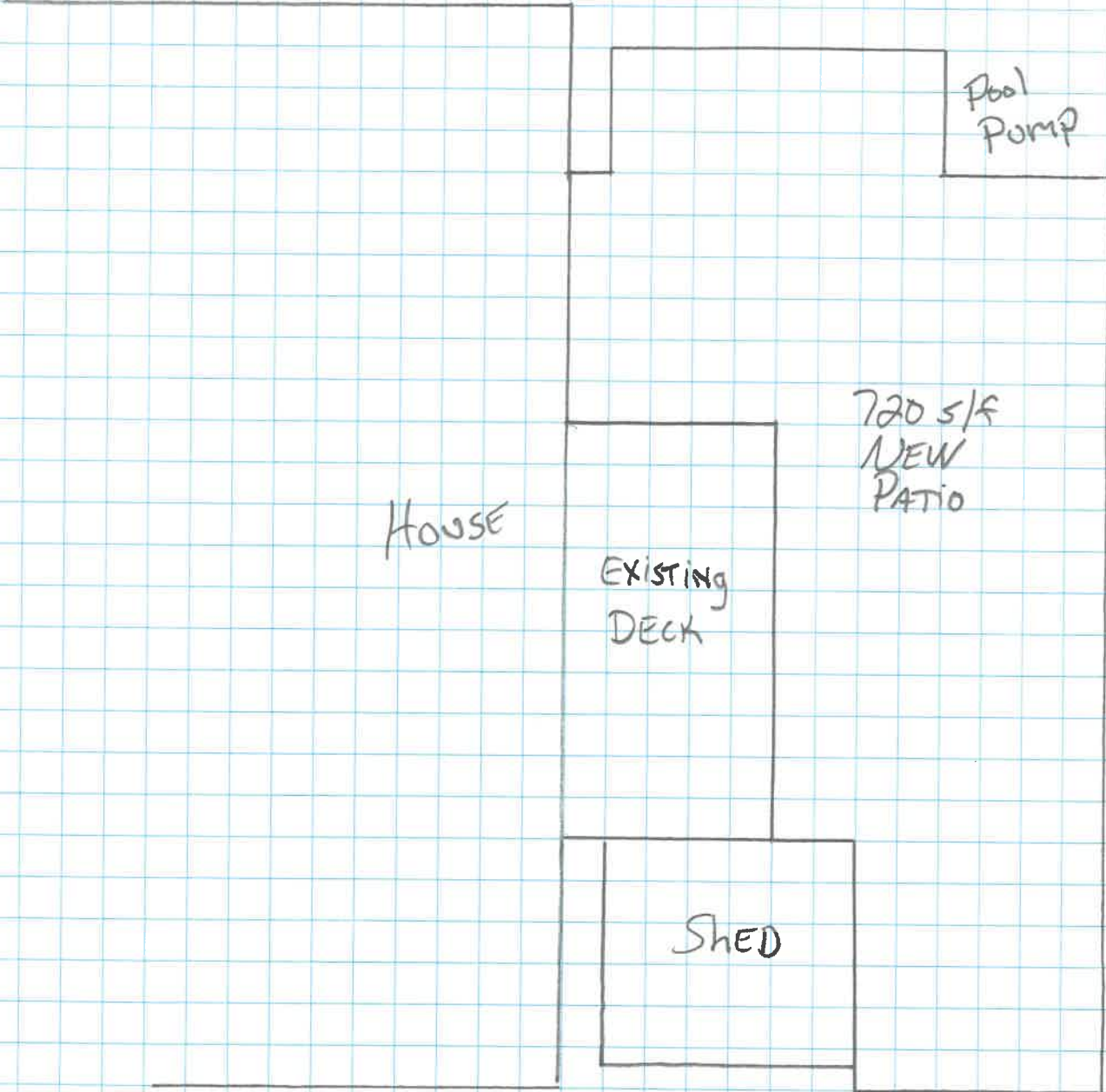

PROPERTY LINE  
32'6" | Pool

4' from water edge

20'6" | PROPERTY LINE



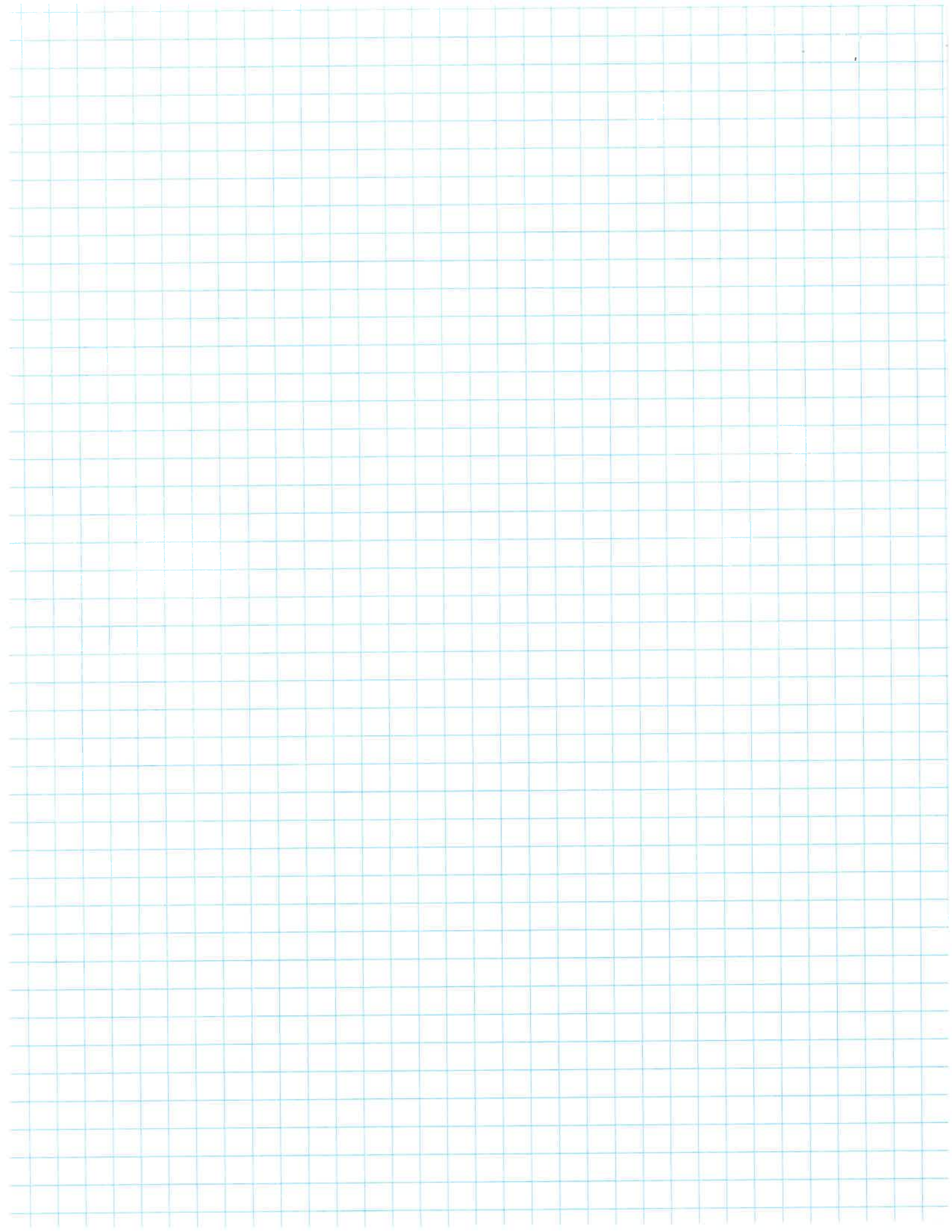

F

**THE CITY OF NAPOLEON**  
**BUILDING & ZONING DEPARTMENT**  
**255 W. RIVERVIEW**  
**(419)592-4010**



---

**Inspections**

Page 1 of 1  
Printed: 5/11/2007

**Address:** 1115 Kenilworth Ave.  
Napoleon, OH 43545

**Applicant:** Hershberger Construction LTD

**Permit Number:** BP2007-53

---

**Inspection Date:** 5/11/2007  
**Inspection Number:** INSP2007-120  
**Inspection Type:** Building Final

**Inspector:** Tom Zimmerman  
**Status:** Complete  
**Passed?**

**Required Steps:**

**Comments:**

---

**Other Fields:**

